

# UNIVERSITI SAINS MALAYSIA

## ***POSTGRADUATE PROGRAMMES & FEES***

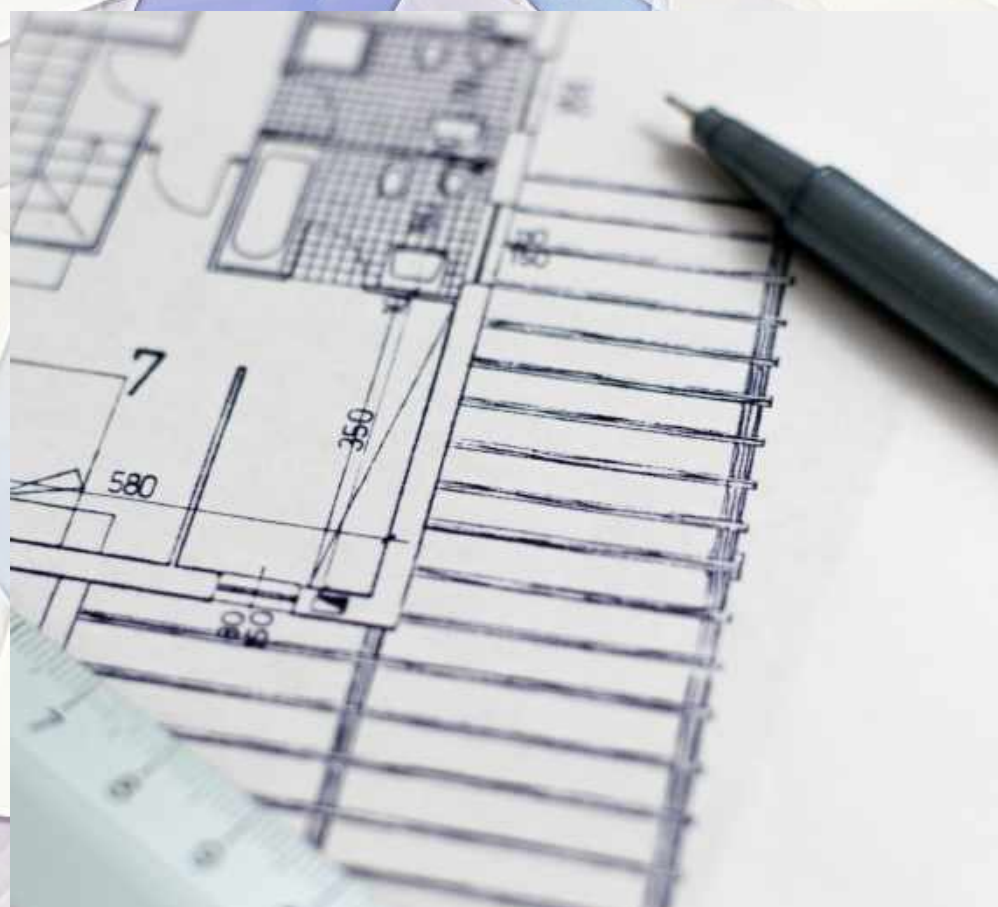

[www.admissions.usm.my](http://www.admissions.usm.my)

[admission\\_ips@usm.my](mailto:admission_ips@usm.my)

+604-6536309 / +604-6532946 / +604-6536027



## Mixed Mode Programmes

	Malaysian (MYR)	International (USD)
Doctor of Business Administration	42,525.00	15,997.50
Doctor of Neuroscience	47,250.00	17,775.00
Doctor of Public Health (Environmental Health and Occupational)	47,250.00	17,662.50
Doctor of Public Health (Epidemiology)	47,250.00	17,662.50
Doctor of Public Health (Family Health)	47,250.00	17,662.50
Doctor of Public Health (Health System Management)	47,250.00	17,662.50
Doctorate in Dental Public Health	45,150.00	16,877.50
Master of Arts (Communication)	10,400.00	3,900.00
Master of Arts (Education) - Curriculum Studies	10,400.00	3,900.00
Master of Arts (Education) - Early Childhood Education	10,400.00	3,900.00
Master of Arts (Education) - Education Management and Administration	10,400.00	3,900.00
Master of Arts (Education) - Educational Psychology	10,400.00	3,900.00
Master of Arts (Education) - Educational Technology and Multimedia	10,400.00	3,900.00
Master of Arts (Education) - English Language Education/ TESOL	10,400.00	3,900.00
Master of Arts (Education) - Malay Language Education	10,400.00	3,900.00
Master of Arts (Education) - Mathematics Education	10,400.00	3,900.00
Master of Arts (Education) - Psychometrics and Educational Measurement	10,400.00	3,900.00
Master of Arts (Education) - Science Education	10,400.00	3,900.00
Master of Arts (Education) - Special Education	10,400.00	3,900.00
Master of Arts (Hadith)*	11,220.00	3,850.00
Master of Arts (Linguistics and English Language Studies)	10,400.00	3,900.00
Master of Arts (Literature)*	10,400.00	3,900.00
Master of Arts (Southeast Asian History)*	10,400.00	3,900.00
Master of Science (Applied Geophysics)	10,600.00	4,000.00
Master of Science (Biomedicine)	10,600.00	4,000.00
Master of Science (Building Technology)	10,720.00	4,000.00
Master of Science (Chemical Instrumentation)	10,600.00	4,000.00
Master of Science (Clinical Anatomy)	16,400.00	6,150.00
Master of Science (Computer Science)	10,720.00	4,000.00
Master of Science (Electronic System Design Engineering)	9,000.00	6,500.00
Master of Science (Electronic System Design Engineering) - Industry candidates	25,900.00	N/A
Master of Science (Embedded System Engineering)	9,000.00	6,500.00
Master of Science (Embedded System Engineering) - Industry candidates	25,900.00	N/A
Master of Science (Environmental Engineering)	10,720.00	4,000.00
Master of Science (Fire Safety Engineering)	12,000.00	6,400.00
Master of Science (Forensic Science)	10,600.00	4,000.00
Master of Science (Health Toxicology)	13,600.00	5,100.00
Master of Science (Materials Engineering)	10,720.00	4,000.00
Master of Science (Mathematics)	10,600.00	4,000.00
Master of Science (Medical Education)	10,720.00	4,000.00
Master of Science (Medical Research)	13,600.00	5,100.00
Master of Science (Medical Statistic)	10,720.00	4,000.00
Master of Science (Microelectronic Engineering)	9,000.00	6,500.00
Master of Science (Microelectronic Engineering) - Industry candidates	25,900.00	N/A
Master of Science (Molecular Medicine)	31,000.00	11,625.00
Master of Science (Nano-Optoelectronics)	12,000.00	4,480.00
Master of Science (Radiation Science)	8,800.00	3,300.00
Master of Science (Solid State Physics) - Dual Degree	10,600.00	4,000.00
Master of Science (Statistics)	10,600.00	4,000.00
Master of Science (Structural Engineering)	10,720.00	4,000.00
Master of Science (Sustainable Cities and Communities)	10,400.00	3,900.00
Master of Science (Tourism Development)	11,440.00	4,290.00
Master of Science (Transfusion Science)	13,600.00	5,100.00
Master of Social Science (Islamic Development Management)	10,400.00	3,900.00
Master of Social Work	11,220.00	4,235.00

\*Malay Language as medium of instructions

## Coursework Mode Programmes

	Malaysian (MYR)	International (USD)
Doctor of Education (Curriculum and Education)	47,250.00	11,940.00
Doctor of Education (Educational Technology and Multimedia)	47,250.00	11,940.00
Doctor of Education (Science Education)	47,250.00	11,940.00
Doctor of Education (TESOL)	47,250.00	11,940.00
Doctor of Psychology (Clinical Neuropsychology) - Joint Degree	63,000.00	63,000.00
Doctor of Psychology (Clinical Psychology) - Joint Degree	63,000.00	63,000.00
Master in Counseling	11,660.00	4,372.50
Master of Architecture	14,080.00	5,280.00
Master of Arts (Translation for Professionals)	12,400.00	4,650.00
Master of Business Administration	23,760.00	9,600.00
Master of Business Administration - Double Degree	Contact us	Contact us
Master of Business Administration - Dual Degree	Contact us	Contact us
Master of Business Administration (Online)	28,800.00	11,940.00
Master of Business Administration (Online) - Dual Degree	Contact us	Contact us
Master of Cognitive Neurosciences	25,300.00	12,650.00
Master of Communication (Integrated Marketing Communication)	15,480.00	5,751.25
Master of Dental Public Health	8,800.00	3,300.00
Master of Economics Management	9,680.00	3,630.00
Master of Informatics	10,720.00	4,000.00
Master of Instructional Multimedia	9,240.00	3,465.00
Master of Landscape Architecture	9,240.00	3,465.00
Master of Pharmacy (Clinical Pharmacy)	14,600.00	5,450.00
Master of Psychology (Clinical Psychology) - Joint Degree	38,500.00	38,500.00
Master of Public Administration	9,680.00	3,630.00
Master of Public Health	10,720.00	4,000.00
Master of Science (Building Technology)	9,680.00	3,630.00
Master of Science (Clinical Exercise Science)	9,240.00	4,000.00
Master of Science (Data Science and Analytics)	11,880.00	4,455.00
Master of Science (Environmental Science)	10,600.00	4,000.00
Master of Science (Medical Physics)	8,800.00	3,300.00
Master of Science (Project Management)	9,680.00	3,630.00
Master of Science (Solid State Physics)	8,800.00	3,300.00
Master of Science (Teaching of Mathematics)	11,395.00	4,300.00
Masters in Sustainable Development Practice	25,652.00	9,625.00

## Clinical Programmes

	Malaysian (MYR)	International (USD)
Master of Medicine (Anaesthesiology)	54,400.00	45,000.00
Master of Medicine (Emergency Medicine)	54,400.00	45,000.00
Master of Medicine (Family Medicine)	54,400.00	45,000.00
Master of Medicine (Internal Medicine)	54,400.00	45,000.00
Master of Medicine (Nuclear Medicine)	54,400.00	45,000.00
Master of Medicine (Obstetrics and Gynaecology)	54,400.00	45,000.00
Master of Medicine (Ophthalmology)	54,400.00	45,000.00
Master of Medicine (Orthopaedics)	54,400.00	45,000.00
Master of Medicine (Otorinolaryngology, Head and Neck Surgery)	54,400.00	45,000.00
Master of Medicine (Paediatrics)	54,400.00	45,000.00
Master of Medicine (Psychiatry)	54,400.00	45,000.00
Master of Medicine (Radiology)	54,400.00	45,000.00
Master of Medicine (Surgery)	54,400.00	45,000.00
Master of Medicine (Transfusion Medicine)	54,400.00	45,000.00
Master of Pathology (Anatomic Pathology)	54,400.00	45,000.00
Master of Pathology (Chemical Pathology)	54,400.00	45,000.00
Master of Pathology (Clinical Immunology)	54,400.00	45,000.00
Master of Pathology (Haematology)	54,400.00	45,000.00
Master of Pathology (Medical Genetics)	54,400.00	45,000.00
Master of Pathology (Medical Microbiology)	54,400.00	45,000.00
Master of Surgery (Neurosurgery)	54,400.00	45,000.00
Master of Surgery (Plastic Surgery)	54,400.00	45,000.00

## One-off fees

	Malaysian (MYR)	International (USD)
Registration fee		
• All programmes	340.00	227.50
• <b>Except</b>		
• Master of Public Administration	540.00	277.50
• Master of Economic Management	540.00	277.50
• Master of Business Administration (Online)	150.00	135.00
Personal Bond	N/A	1000.00
Thesis Evaluation Fee - Master	750.00	250.00
- Ph.D	1,000.00	375.00
Convocation Fee	200.00	50.00

## Research Mode Programmes

	Malaysian (MYR)		International (USD)	
	Full Time/sem	Part Time/sem	Full Time/sem	Part Time/sem
Advanced Medical and Dental Institute	4,200.00	3,585.00	1,575.00	1,425.00
Analytical Biochemistry Research Centre	4,200.00	3,600.00	1,600.00	1,400.00
Centre for Chemical Biology	3,350.00	2,775.00	1,250.00	1,113.00
Centre for Drug Research	4,150.00	3,535.00	1,550.00	1,400.00
Centre for Global Archaeological Research	2,900.00	2,385.00	1,088.00	963.00
Centre for Global Sustainability Studies (Arts)	3,050.00	2,515.00	1,150.00	1,025.00
Centre for Global Sustainability Studies (Sciences)	3,550.00	2,975.00	1,325.00	1,188.00
Centre for Instructional Technology and Multimedia	3,050.00	2,515.00	1,150.00	1,025.00
Centre for Islamic Development Management Studies	3,350.00	2,775.00	1,088.00	963.00
Centre for Marine and Coastal Studies	2,900.00	2,385.00	1,250.00	1,113.00
Centre for Policy Research and International Studies	2,900.00	2,385.00	1,088.00	963.00
Collaborative Microelectronic Design Excellence Centre	3,700.00	3,085.00	1,388.00	1,238.00
Graduate School of Business	3,400.00	2,865.00	1,275.00	1,150.00
Institute for Research in Molecular Medicine	4,200.00	3,585.00	1,575.00	1,425.00
Institute of Nano-Optoelectronics Research and Technology	4,150.00	3,535.00	1,550.00	1,400.00
Malaysian Institute of Pharmaceuticals and Nutraceuticals	4,150.00	3,535.00	1,550.00	1,400.00
National Advanced IPv6 Centre	4,150.00	3,535.00	1,550.00	1,400.00
National Higher Education Research Institute	2,900.00	2,385.00	1,088.00	963.00
National Poison Centre	4,150.00	3,535.00	1,550.00	1,400.00
River Engineering and Urban Drainage Research Centre	3,700.00	3,085.00	1,388.00	1,238.00
School of Aerospace Engineering	3,700.00	3,085.00	1,388.00	1,238.00
School of Arts	3,050.00	2,515.00	1,150.00	1,025.00
School of Biological Sciences	3,350.00	2,775.00	1,250.00	1,113.00
School of Chemical Engineering	3,700.00	3,085.00	1,388.00	1,238.00
School of Chemical Sciences	3,350.00	2,775.00	1,250.00	1,113.00
School of Civil Engineering	3,700.00	3,085.00	1,388.00	1,238.00
School of Communication	3,050.00	2,515.00	1,150.00	1,025.00
School of Computer Sciences	4,150.00	3,535.00	1,550.00	1,400.00
School of Dental Sciences	4,200.00	3,585.00	1,575.00	1,425.00
School of Distance Education (Arts)	2,900.00	2,385.00	1,088.00	963.00
School of Distance Education (Sciences)	3,350.00	2,775.00	1,250.00	1,113.00
School of Educational Studies	3,050.00	2,515.00	1,150.00	1,025.00
School of Electrical and Electronic Engineering	3,700.00	3,085.00	1,388.00	1,238.00
School of Health Sciences	4,100.00	3,525.00	1,538.00	1,400.00
School of Housing, Building and Planning	3,550.00	2,975.00	1,325.00	1,188.00
School of Humanities	2,900.00	2,385.00	1,088.00	963.00
School of Industrial Technology	3,550.00	2,975.00	1,325.00	1,188.00
School of Languages, Literacies and Translation	2,900.00	2,385.00	1,088.00	963.00
School of Management	3,400.00	2,865.00	1,275.00	1,150.00
School of Materials and Mineral Resources Engineering	3,700.00	3,085.00	1,388.00	1,238.00
School of Mathematical Sciences	3,350.00	2,775.00	1,250.00	1,113.00
School of Mechanical Engineering	3,700.00	3,085.00	1,388.00	1,238.00
School of Medical Sciences	4,200.00	3,585.00	1,575.00	1,425.00
School of Pharmaceutical Sciences	4,150.00	3,535.00	1,550.00	1,400.00
School of Physics	3,350.00	2,775.00	1,250.00	1,113.00
School of Social Sciences	2,900.00	2,385.00	1,088.00	963.00
Women's Development Research Centre	3,350.00	2,775.00	1,250.00	1,113.00

## Disclaimers

- Fees are subject to change.
- Final fees should be confirmed before any commitment to be made.
- Any discrepancies on the fees, the correct amount by USM Bursary are to be used.

